

DEVIATION DE GIRAC

VISE par l'ingénieur des T.P.E.

Id : 27 AVR. 1983

E		
D	24.04.85	Bon pour visé.
C	17.06.85	Modifier suivant appel téléphonique SETI
B	11.07.85	Modifier au n° 42.2.3.6 Août 1984
A	DATE 23/7/85	ETABLISSEMENT DU DOCUMENT

5 RUE DES TUILERIES LES GRANGES GALANDS
ST AVERTIN 37170 CHAMBRAY LES TOURS FRANCE
TELEPHONE (47) 27 41 97 TELEX 751677 F

BP. 360
79 001 NIORT Cedex
tél. (49) 08-06-86

DESIGNATEUR	INGENIEUR	VERIFICATEUR	ECHELLE	PROJET N°	DOCUMENT	IND
J.P.C.	F.C.		1/20	27156.01	04	D

— DETAIL DE FRETTAGE —

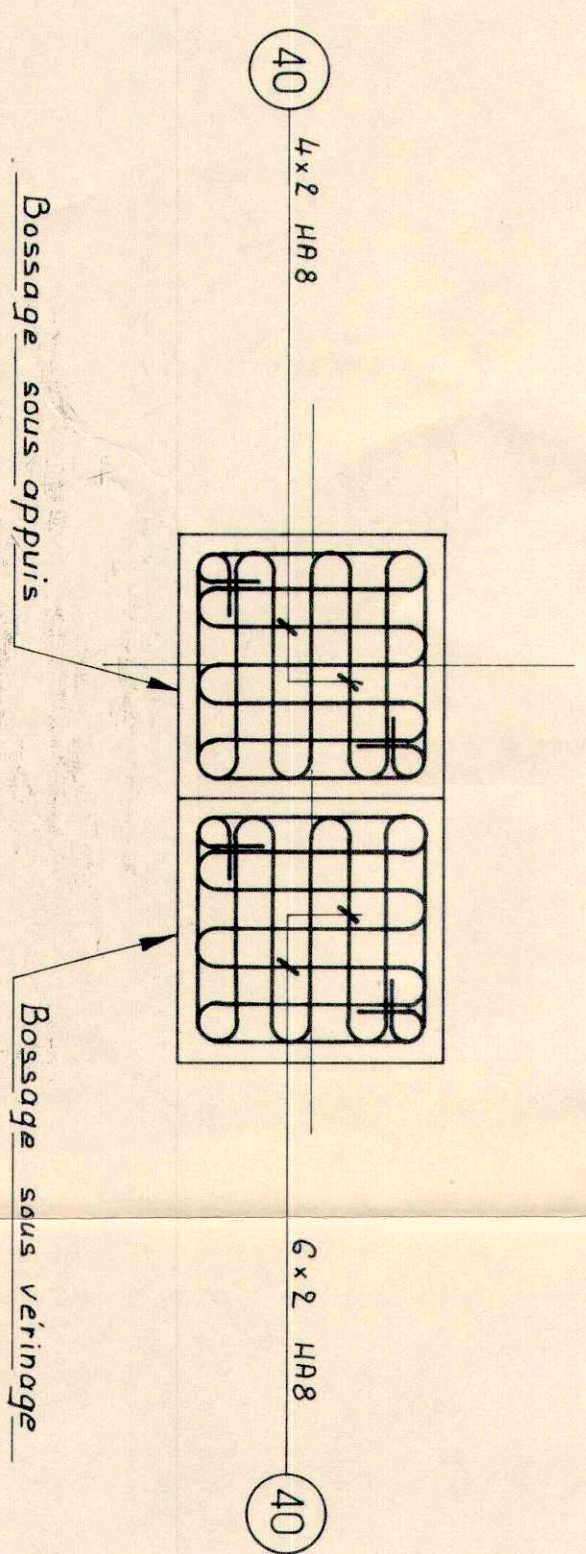

(ulée 1, côté Bordeaux — (ulée 2, côté Paris

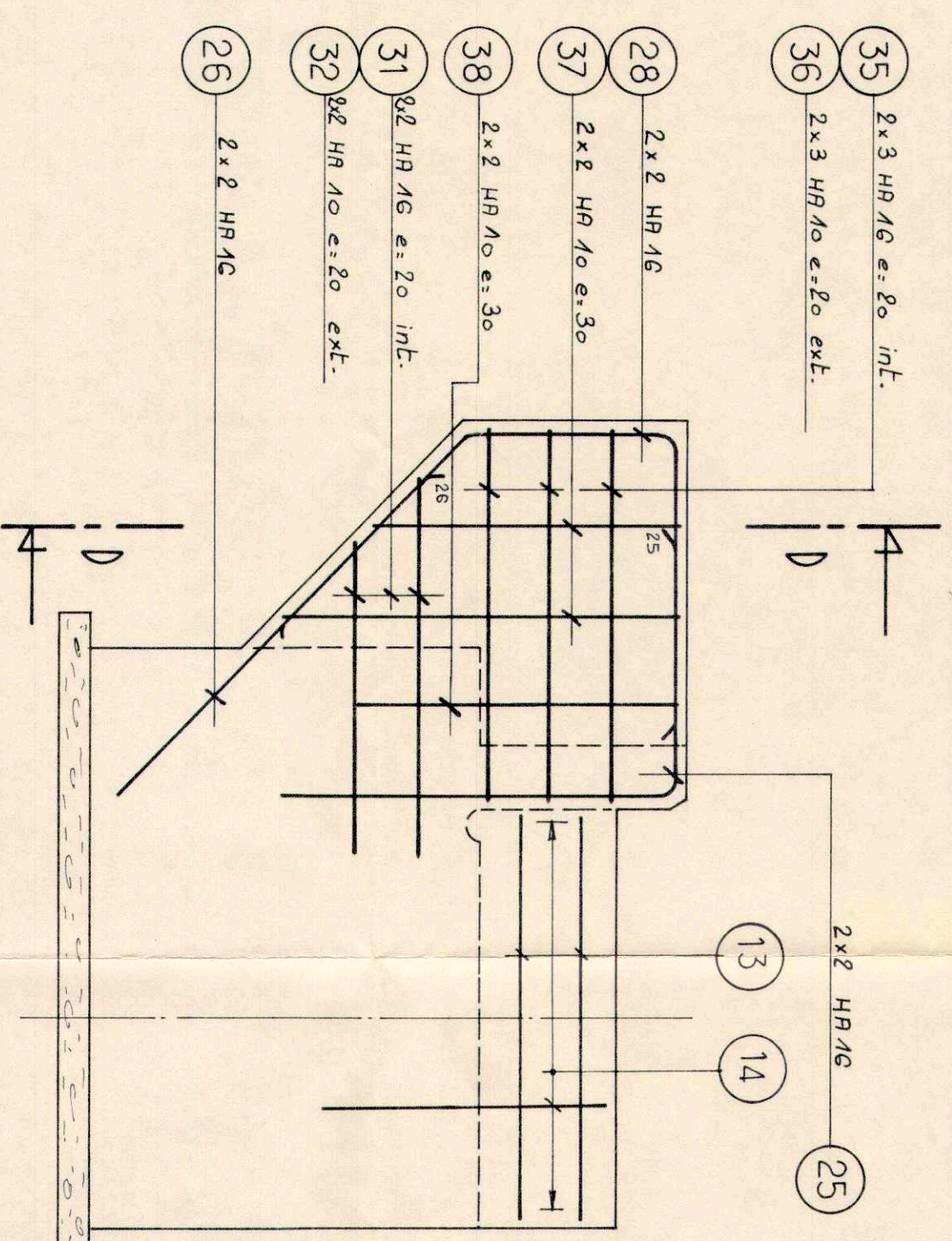

Technical drawing of a reinforced concrete slab (Table 10) showing a plan view and a cross-section. The plan view shows a rectangular slab with dimensions 3.30m by 3.30m. It includes reinforcement details: top bars (1, 2, 3, 4, 5, 6, 7, 8, 9, 10, 11, 12) and bottom bars (13, 14, 15, 16, 17, 18, 19, 20, 21). The cross-section shows a slab thickness of 15cm and a total height of 25cm. The drawing is labeled "Tableau 10" and "Figure 10".

Technical drawing of a roof structure, showing a plan view and a cross-section.

Plan View (Top):

- Shows a rectangular roof layout with a central ridge and two gables.
- Dimensions: 24 m (width), 23 m (length), 22 m (length), 21 m (length).
- Labels: 1, 2, 3, 4, 5, 6, 7, 8, 9, 10, 11, 12, 13, 14, 15, 16, 17, 18, 19, 20, 21, 22, 23, 24.
- Notes: 24 m, 23 m, 22 m, 21 m, 20 m, 19 m, 18 m, 17 m, 16 m, 15 m, 14 m, 13 m, 12 m, 11 m, 10 m, 9 m, 8 m, 7 m, 6 m, 5 m, 4 m, 3 m, 2 m, 1 m.

Cross-section (Bottom):

- Shows the profile of the roof structure, including the ridge and gables.
- Dimensions: 24 m (width), 23 m (length), 22 m (length), 21 m (length).
- Labels: 1, 2, 3, 4, 5, 6, 7, 8, 9, 10, 11, 12, 13, 14, 15, 16, 17, 18, 19, 20, 21, 22, 23, 24.
- Notes: 24 m, 23 m, 22 m, 21 m, 20 m, 19 m, 18 m, 17 m, 16 m, 15 m, 14 m, 13 m, 12 m, 11 m, 10 m, 9 m, 8 m, 7 m, 6 m, 5 m, 4 m, 3 m, 2 m, 1 m.

[illegible]

—(OUPF (—